

USER MANUAL

OA Kneetrac™



Bi-Compartmental OA Knee Decompression



**Thank you for choosing DDS
and welcome to an enjoyable life,
free from knee pain.**

www.DDSbelt.com

Table of Contents

- 3 Table of Contents
- 4 Safety Warnings
- 5 What's Inside the Box
- 6 How to Wear the Product
- 8 Angle Lock System
- 9 How to Secure the Angle Stopper
- 10 OA Kneetrac™ Knee Extension Overview
- 12 Maintenance
- 13 Warranty
- 14 Registration & Warranty Card

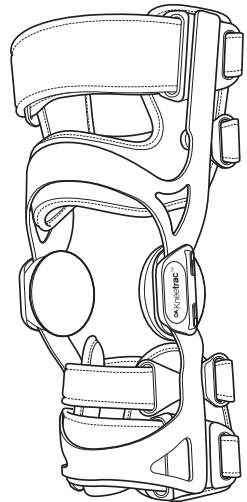

Safety Warnings

- 1 READ this manual carefully to ensure proper use of the OA Kneetrac™.
- 2 ALWAYS follow the advice of your physician before wearing the brace.
- 3 DO NOT wear an OA knee brace on both knees at the same time.
- 4 IMMEDIATELY discuss with a specialist if you feel any discomfort, pain, swelling and/or poor blood circulation. It's especially important for patients with peripheral vascular disease, neuropathy and/or sensitive skin.

What's Inside the Box

OA **Kneetrac**™

Front

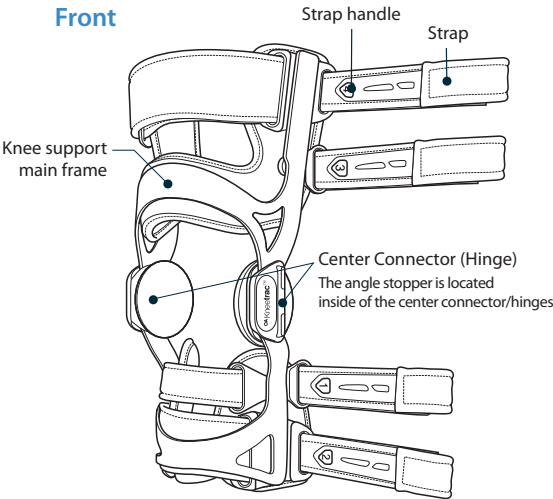

Back

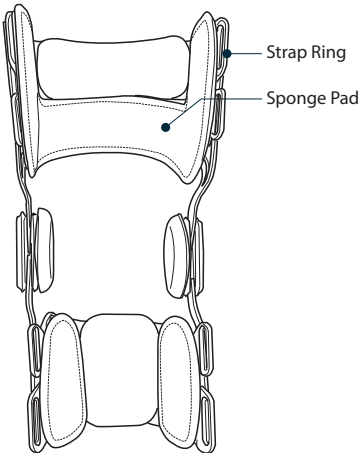

Rigid Guard

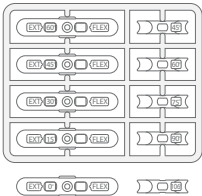

Angle Stoppers



Allen Key

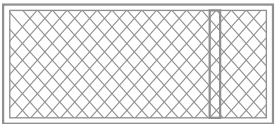

Laundry Bag



Manual

How to Wear the Product



The brace must only be worn on the knee it was assigned to by your physician.

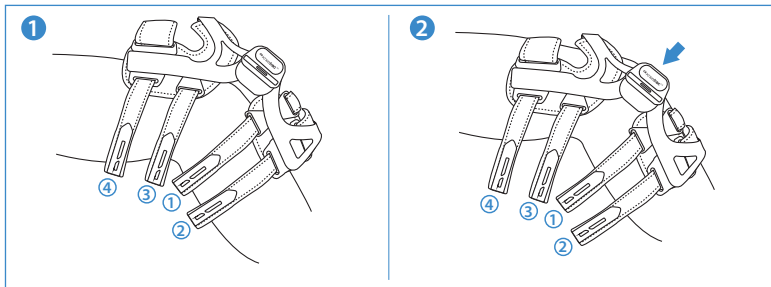

Sit on a stable chair and extend your leg. Place the brace on your knee so that the hinge is centered with the knee.

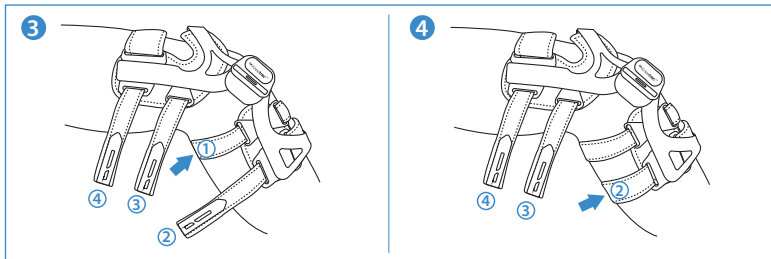

With the leg extended and only slightly bent, fasten strap #1 (as indicated on the handle) first. Then, apply strap #2 in the same fashion.

How to Wear the Product

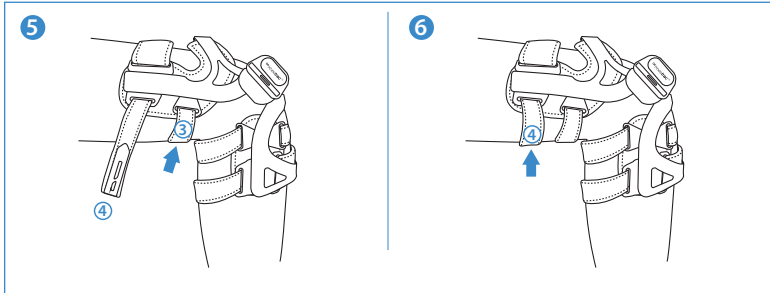

Bend the knee in a 90° angle when fastening straps #3 and #4. If the center connector (hinge) is too high or too low compared to the knee, adjust the height appropriately.

OPTIONAL : The length of each strap can also be adjusted

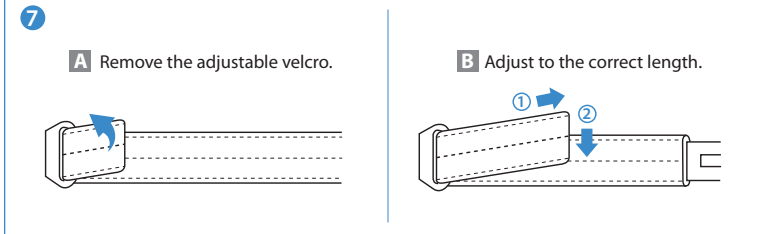

IMPORTANT: The center connector(hinge) must be precisely aligned with the knee. After securing the Brace, take a few steps to check your comfort as well as the traction strength.

Straps that are too tight can cause poor blood.

Straps that are too loose will not provide the desired traction.

Angle Lock System

IMPORTANT: Only use the Angle Locks when recommended by your physician.

Angle Stopper

The Angle Lock System controls the angle and the range of motion with respect to knee extension and knee flexion by combining various EXT and FLEX Angle Stoppers.

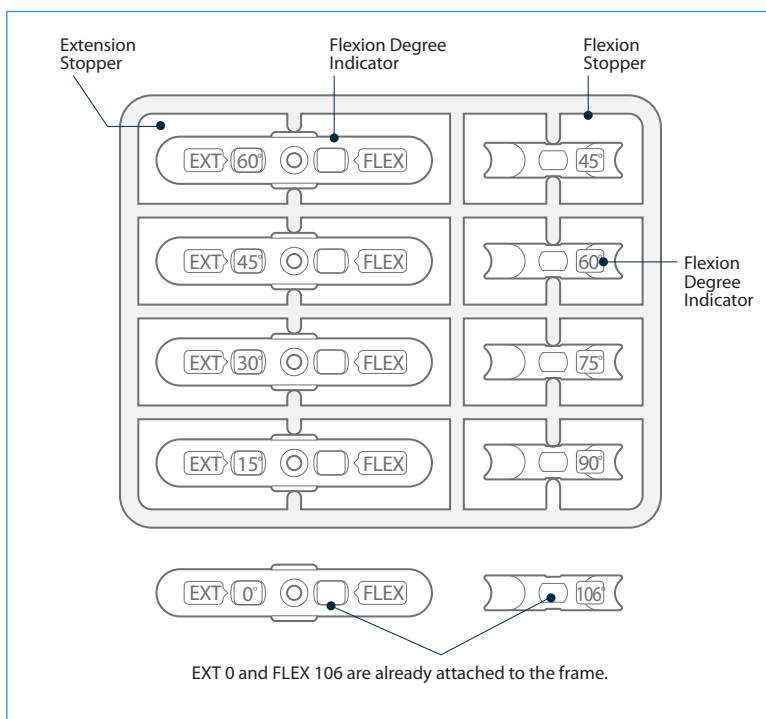

- EXT Stoppers control the degree of knee extension.
- FLEX Stoppers control the degree of knee bend.

How to Secure the Angle Stopper

**The Angle Lock System is installed inside the center connector(hinge).
Remove the sponge padding to access.**

- Attach the flexion stopper [A] with the extension stopper [B] so that the flexion degree [C] snaps in to the flexion degree indicator [D].
- Tighten the screw [E] with the allen key to attach stoppers to the Hinge [F].

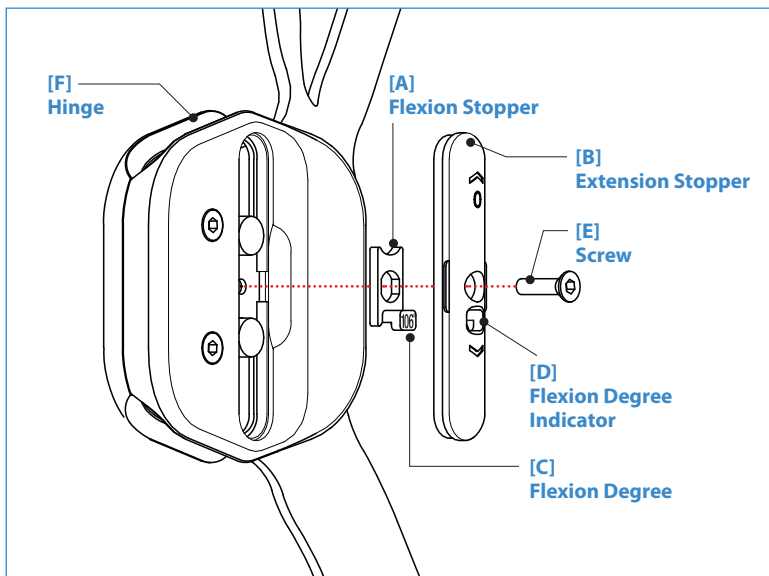

The Angle Stopper must be applied to both sides of the brace.

OA Kneetrac™ Knee Extension Overview

Increasing EXT degree while keeping FLEX at 106° restricts the extension of the knee.

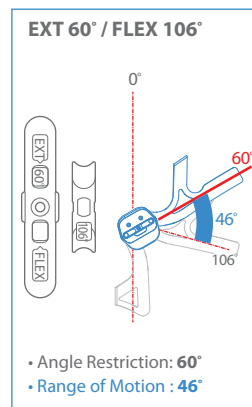
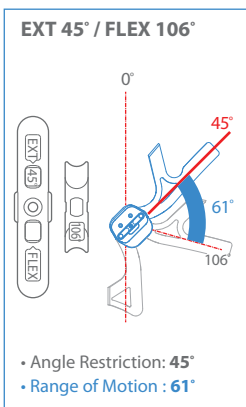
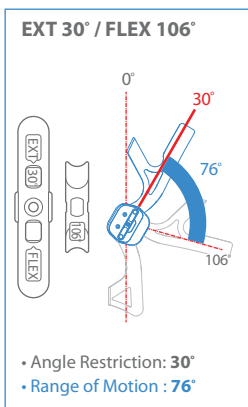
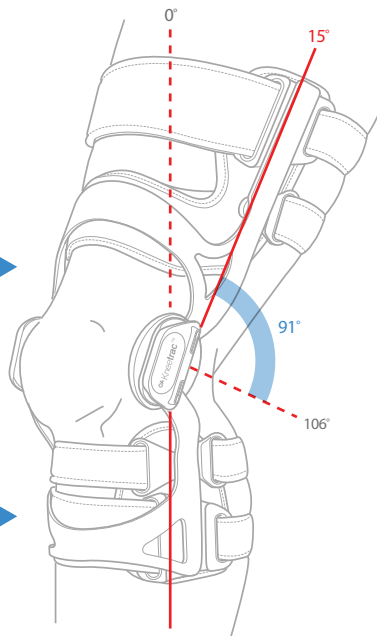
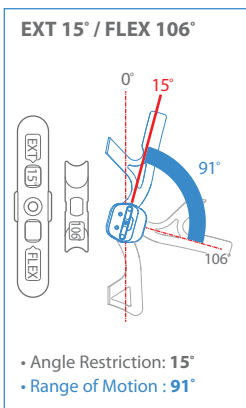
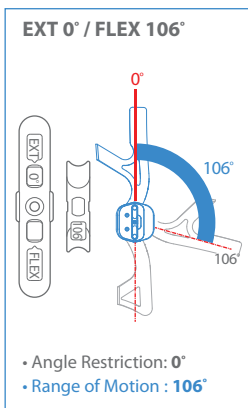

OA Kneetrac™ Knee Flexion Overview

Decreasing FLEX degree while keeping EXT at 0° restricts the bending of the knee.

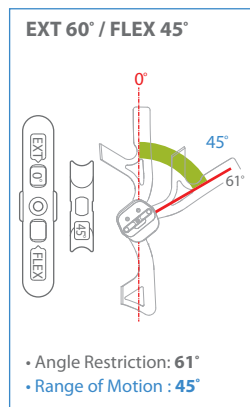
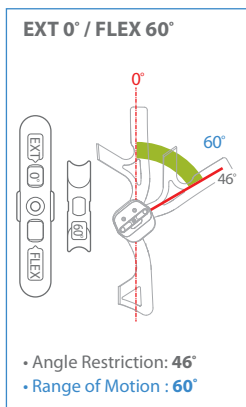
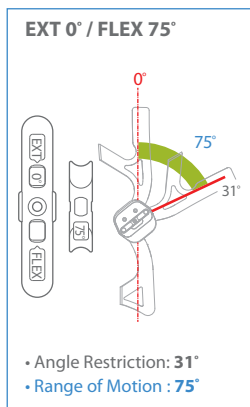
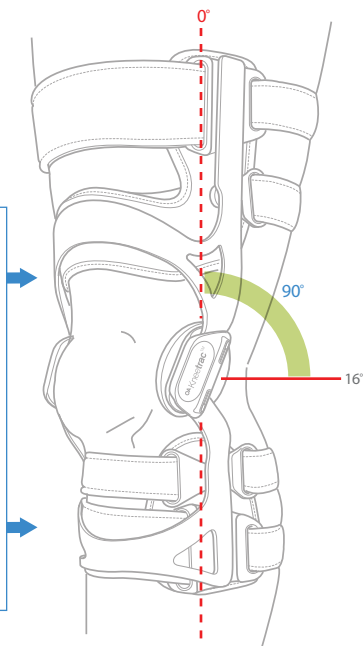
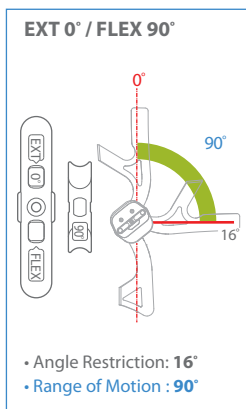
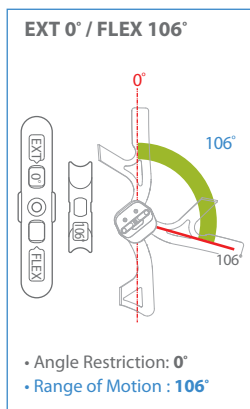

Maintenance for OA Kneetrac™

- 1 Main Frame of the Knee Brace
 - Clean with a damp cloth and let it dry in the shade.
- 2 Sponge Pads
 - Remove the sponge pads and place them in the laundry bag provided with the Brace.
 - Use neutral detergent and select a light cycle.
 - Air dry in the shade. Only use when completely dry.



DO NOT
IRON



DO NOT
BLEACH



DO NOT
DRY-CLEAN



DO NOT
WRING

Warranty

Limited 1 Year Warranty

DDS, Inc. will repair or replace the unit free of charge for a 1 year period from the date of purchase. The warranty is covered only if the device is defective in workmanship or materials.

To obtain service under this warranty, please mail the warranty card at the time of purchase. You may then return the defective product to the service center on the warranty card, together with your purchase receipt and \$5.00 postage and handling. In the absence of a purchase receipt, an invoice must to be produced from the seller. This warranty does not apply for any misuse and/or deliberate mishandling of our products.

Any implied warranty, obligations or liabilities, including but not limited to the implied warranty of merchantability fitness for a particular purpose, shall be limited in duration to the 1 year duration of this written, limited warranty. Some states do not allow limitations on how long an implied warranty lasts, so the limitations may not apply to you.

In no event shall DDS be liable for any special, incidental or consequential damages for breach of any other warranty, express or implied whatsoever. Some states do not allow the exclusion and the limitation may not apply to you.

This warranty gives you specific legal rights. These rights may vary according to your state laws.



Registration / Warranty Card

FIRST NAME: _____ MI: _____ LAST: _____

ADDRESS 1: _____

ADDRESS 2: _____

CITY: _____ STATE: _____ ZIP: _____

PHONE (DAY): _____ (EVENING) _____

PRODUCT INFORMATION

DATE OF PURCHASE: _____

DDS MODEL:

DDS OA Kneetrac™

HOW DID YOU BECOME AWARE OF DDS?

MAIL TO SERVICE CENTER:

DDS, INC.

100 Commerce Way, Suite 5

Hackensack, NJ 07601 U.S.A.

OA Kneetrac™

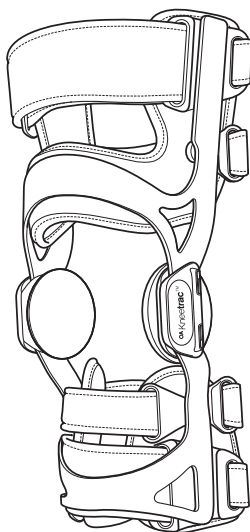

www.DDSbelt.com

Disc Disease Solutions, Inc.

100 Commerce Way, Suite 5
Hackensack, NJ 07601
U.S.A.

Tel: (888) 495-7440

Fax: (201) 880-7799

info@discdiseasesolutions.com

For Canada please contact

Tel: (204) 470-5741

canada@discdiseasesolutions.com